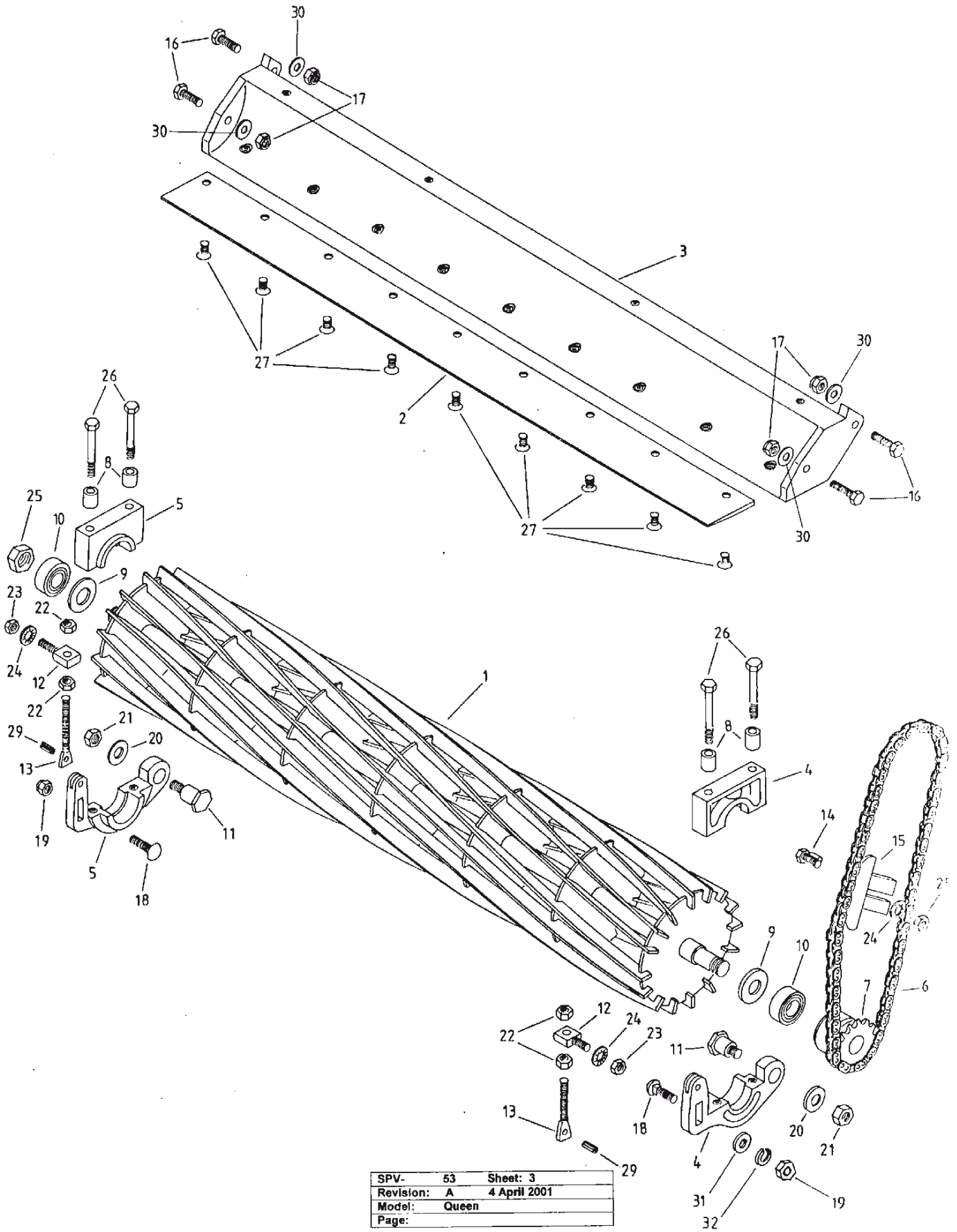

Image A



30" QUEEN™ - SPARE PARTS LIST

ITEM	PART No.	DESCRIPTION
1	306122	Blade cutter assembly- 10 blades
1	10168	Blade cutter assembly- 16 blades
2	393000	Bottom blade- low cut
3	301735	Sole plate
4	301647	Cutter bearing housing assembly- LH
5	301698	Cutter bearing housing assembly- RH
6	2986519	Chain- countershaft to cutter
7	165340	Cutter sprocket
8	301680	Hanger cap bolt spacer
9	163432	Bearing cover washer
10	A07744	Cutter bearing
11	163440	Bearing housing pivot bolt
12	301727	Cutter adj.screw purchase block
13	301719	Cutter adjustment screw
14	161461	Chain adjuster bolt assembly
15	161453	Chain adjuster
16	1213325	Bolt- 7/16" x 1-1/4" unf.HT.
17	2641238	Nyloc nut- 7/16" unf.
18	A04069	Bolt- 3/8" x 1-1/4" unc.cuphead
19	A02007	Nut- 3/8" unc.Hex
20	A02063	Washer- 1/2" x 1" x 16g.flat
21	A02046	Nut- 1/2" unf.hex.
22	2321182	Nut- 5/16" unf.hex.
23	A02060	Nut- 3/8" unf.hex.
24	A02034	Washer- 3/8" shakeproof
25	2671289	Locknut- 3/4" unf.left hand
26	1185887	Bolt- 5/16" x 3" unc.
27	2071924	Screw- 5/16" x 1/2" csk.M/T.
28	A02060	Nut- 3/8" unf.hex.
29	2211047	Roll pin- 3/16" x 1/2"
30	A02035	Washer- 7/16" x 7/8" x 16g.flat
31	A04033	Washer- 3/8" x 3/4" x16g.flat
32	A04112	Washer- 3/8" spring

Image B

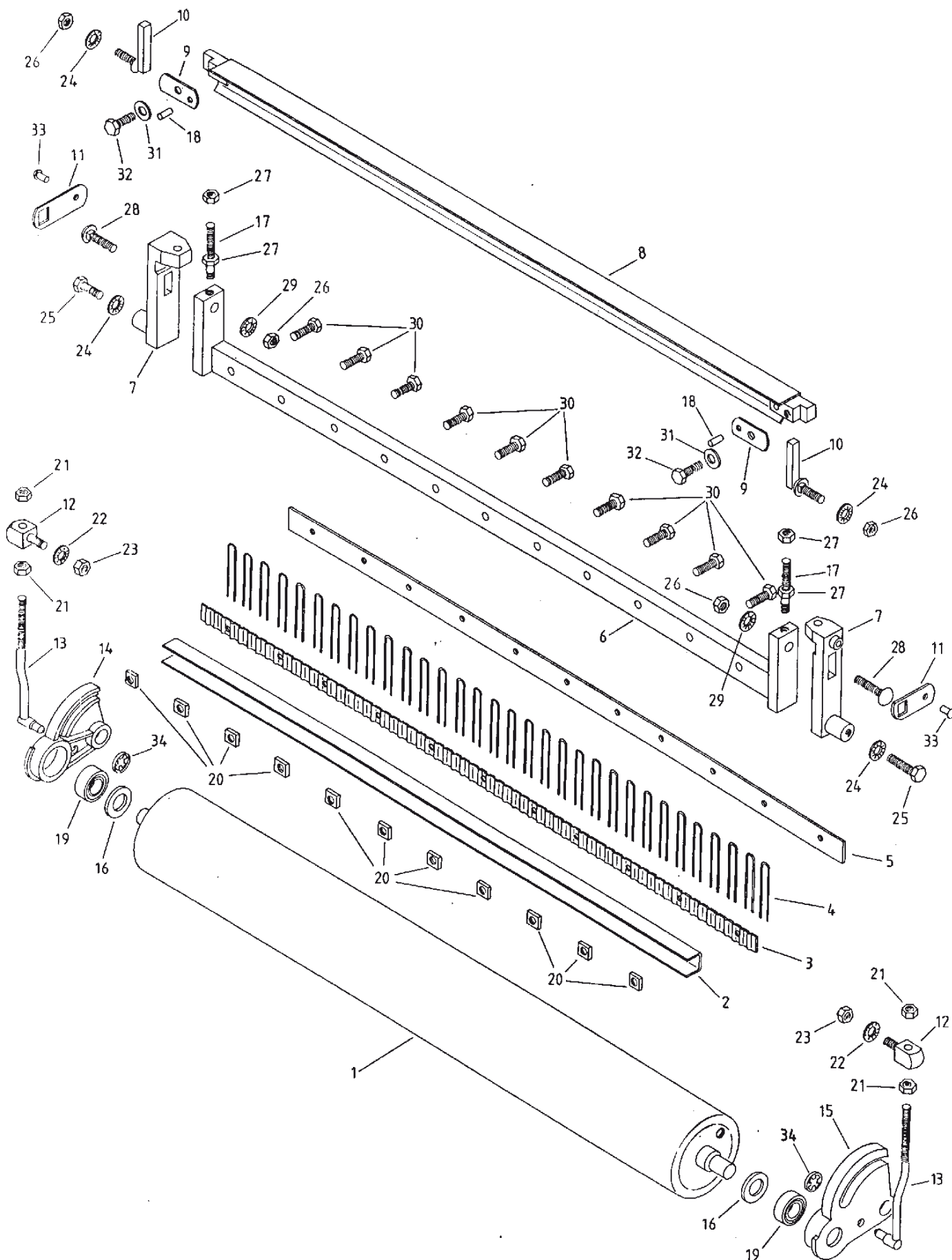

SPV-	53	Sheet: 4
Revision:	A	17 February 2000
Model:	Queen	
Page:		

30" QUEEN™ - SPARE PARTS LIST

ITEM	PART No.	DESCRIPTION
1	301516	Front roller assembly
2	304506	Clamping channel
3	304514	Clamping tyne guide
4	166246	Rake tynes- 32 per set
5	304522	Clamping rubber
6	304485	Rake bar assembly
7	303423	Rake bar mounting bracket
8	303440	Front roller scrape bar assembly
9	303490	Scraper clamp plate
10	303503	Scraper bolt assembly
11	303431	Mounting bracket support
12	301583	Adjusting rod purchase block
13	301559	Front roller adjusting rod assembly
14	301049	Front roller bracket- RH
15	301030	Front roller bracket- LH
16	301057	Bearing seal washer
17	303407	Height adjusting stud
18	2211047	Roll pin- 3/16" x 1/2"
19	1122327	Front roller bearing
20	2491162	Nut- 1/4" sq.pressed w/series AF.445
21	A02060	Nut- 3/8" unf.hex.
22	A02031	Washer- 5/16" shakeproof
23	2321182	Nut- 5/16" unf.hex
24	A02034	Washer- 3/8" shakeproof
25	A04144K	Setscrew- 3/8" x 1" unf.HT. Grade 8
26	A02007	Nut- 3/8" unc.hex.
27	232116	Nut- 1/4" unf.hex
28	A07769	Bolt- 3/8" x 1-1/2" unc.cuphead
29	A02034	Washer- 3/8" shakeproof
30	A02169	Setscrew- 1/4" x 1" unc.
31	A02030	Washer- 5/16" x 5/8" x 18g.flat
32	3182102	Setscrew- 5/16" x 1" unf.HT.
33	1841057	Pin- 1/2" x No:10
34	2501108	Starlock- 7301/0008 1/4" Advel

30" QUEEN™ - SPARE PARTS LIST

ITEM	PART No.	DESCRIPTION
1	305648	Deflector assembly
2	301065	Deflector strip assembly
3	305664	Scraper trough assembly
4	305701	Trough pivot bar
5	305920	Motor table
6	302076	Table seat block
7	302084	Seat block clamp
8	305728	Trough cover plate assembly
9	305752	Trough support
10	2051907	Metal thread- 1/4" x 1/2" round head
11	A02001	Nut- 1/4" unc.hex.
12	A02146	Setscrew- 1/4" x 3/4" unc.hex.
13	A02060	Nut- 3/8" unf.hex.
14	A02034	Washer- 3/8" shakeproof
15	2321182	Nut- 5/16" unf.hex.
16	A02031	Washer- 5/16" shakeproof
17	A02085	Bolt- 5/16" x 1" unc.cuphead
18	A02004	Nut- 5/16" unc.hex.